

2126 W 34th Avenue
Vancouver,

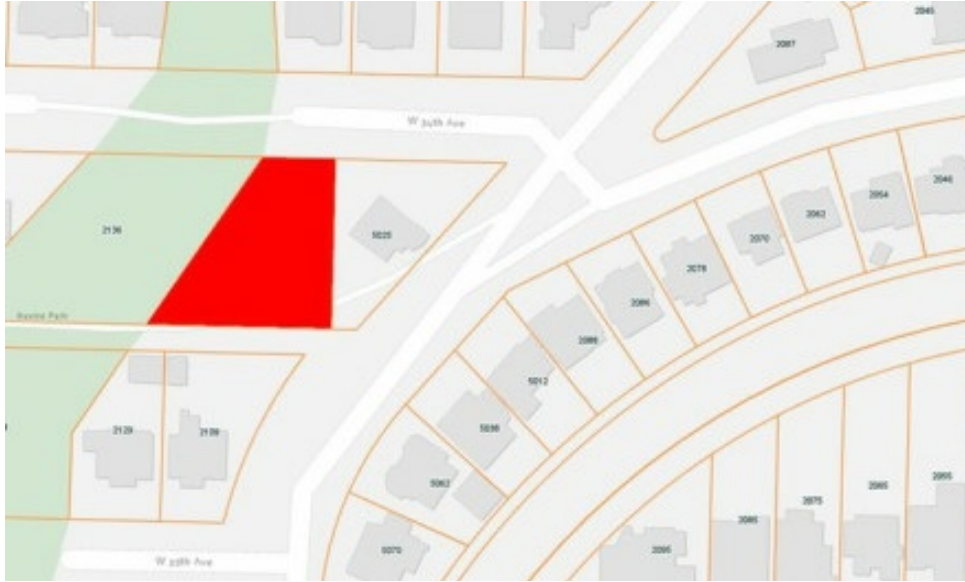

Powered by homes.langleyadvancetimes.com

MLS# R2505134



\$5,000,000

2 Bedrooms | 4 Bathrooms | 2,500 Sqft

Developer Alert! This prime property boasts nearly 13,000 sq ft next to Ravine Park which winds through Arbutus Ridge between Kerrisdale and Prince of Whales Park. It is possible to re-zone for multi-family use. This property also offers potential views of Vancouver City and the North Shore Mountains is a highly desirable central & quiet location.



Julia Greene

Phone: (604) 219-1745

Team 3000 Realty Ltd

Office: (778) 297-3000

For full listing details, please scan:

